

Flush and extended pushbuttons

Non-illuminated and illuminated

Momentary and maintained

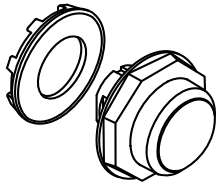

Flush

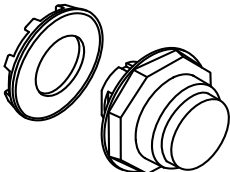

Extended

Δ Non-illuminated
button color

R Red
G Green
Y Yellow
L Blue
W White
B Black
C Clear

‡ Illuminated
button color

R Red
G Green
Y Yellow
L Blue
W White
C Clear

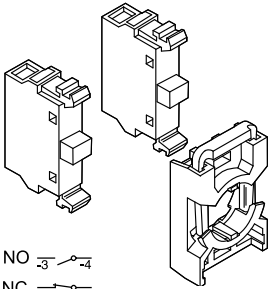

NO $\overline{3}$ \rightarrow $\overline{4}$
NC $\overline{1}$ \rightarrow $\overline{2}$

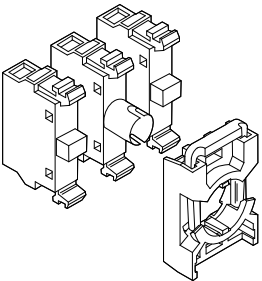

Non-illuminated

| Description | Catalog number |
|----------------------------|------------------|
| Black plastic bezel | |
| Flush, momentary | G1MP1-10Δ |
| Flush, maintained | G1MP2-10Δ |
| Extended, momentary | G1MP3-10Δ |
| Extended, maintained | G1MP4-10Δ |
| Chrome bezel | |
| Flush, momentary | G2MP1-30Δ |
| Flush, maintained | G2MP2-30Δ |
| Extended, momentary | G2MP3-30Δ |
| Extended, maintained | G2MP4-30Δ |

Illuminated^①

| Description | Catalog number |
|----------------------------|------------------|
| Black plastic bezel | |
| Flush, momentary | G1MP1-11‡ |
| Flush, maintained | G1MP2-11‡ |
| Extended, momentary | G1MP3-11‡ |
| Extended, maintained | G1MP4-11‡ |
| Chrome bezel | |
| Flush, momentary | G2MP1-31‡ |
| Flush, maintained | G2MP2-31‡ |
| Extended, momentary | G2MP3-31‡ |
| Extended, maintained | G2MP4-31‡ |

Contact blocks, lamp block and holder ^②

| Blocks | Catalog number | Ref. code |
|--|-----------------|--------------------|
| 1 NO with holder | MCBH-10 | 1SFA 611 605 R1101 |
| 1 NC with holder | MCBH-01 | 1SFA 611 605 R1110 |
| 2 NO with holder | MCBH-20 | 1SFA 611 605 R1102 |
| 2 NC with holder | MCBH-02 | 1SFA 611 605 R1120 |
| 1 NO + 1 NC with holder | MCBH-11 | 1SFA 611 605 R1111 |
| 1 NO + 1 LB with holder | MCBH-101 | 1SFA 611 605 R1201 |
| 1 NC + 1 LB with holder | MCBH-011 | 1SFA 611 605 R1210 |
| 2 NO + 1 LB with holder ^① | MCBH-201 | 1SFA 611 605 R1202 |
| 2 NC + 1 LB with holder | MCBH-021 | 1SFA 611 605 R1220 |
| 1 NO + 1 NC + 1 LB with holder | MCBH-111 | 1SFA 611 605 R1211 |
| 1 NO without holder | MCB-10 | 1SFA 611 610 R1001 |
| 1 NC without holder | MCB-01 | 1SFA 611 610 R1010 |
| Lamp block for 2 W, max 230 V AC/DC bulb or LED | MLB-1 | 1SFA 611 620 R1001 |
| Holder for 3 blocks | MCBH-00 | 1SFA 611 605 R1100 |

Ordering example

Requested: A modular pushbutton, momentary,
with red flush button and one NO contact.

Ref.: 1 piece of G1MP1- 40R +1 piece of MCBH-10

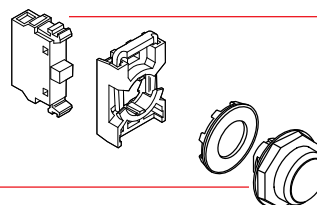

^① No contact block in the center position.

^② Lamp block MLB-1. Bulb not included. Other lamp block see Accessories, bulb max 1.2 W.